

BIMETALLIC STEAM TRAPS AND AIR ELIMINATORS BM35 (1/2" – 1"; DN 15 – DN 25)

DESCRIPTION

BM35 series bimetallic steam traps and air eliminators are simple and robust traps, recommended for steam where condensate sensible heat can be recovered, steam tracing lines, drip points, storage tank coils, steam air venting, etc. The use of condensate sensible heat reduces the steam consumption.

Connections are female screwed, socket weld, butt weld or flanged.

MAIN FEATURES

- Modulating discharge.
- Discharges condensate below steam temperature.
- Excellent air discharge.
- Operates on superheated steam.
- Unaffected by water-hammer and vibrations.
- Built-in strainer.



- USE:** Saturated and superheated steam.
- AVAILABLE MODELS:** BM35.
- SIZES:** 1/2" to 1"; DN 15 to DN 25.
- CONNECTIONS:** Female screwed BSP or NPT.
Flanged EN 1092-1 or ANSI.
SW - Socket weld to ANSI B 16.11.
BW - Butt weld to ANSI B 16.25.
- INSTALLATION:** Horizontal installation recommended, can be installed in any position.
See IMI installation and maintenance instructions.

| BODY LIMITING CONDITIONS | | | |
|--------------------------|------------------------|-------------------------------|---------------------|
| FLANGED PN40 | FLANGED ANSI 300 lb ** | FLANGED PN63/100/ANSI 600 lb* | RELATED TEMPERATURE |
| ALLOW. PRESS. | ALLOW. PRESS. | ALLOW. PRESS. | |
| 40 bar | 50 bar | 63 bar | 50 °C |
| 30,4 bar | 41,8 bar | 48 bar | 250 °C |
| 27,6 bar | 38,9 bar | 43,5 bar | 300 °C |
| 18,5 bar | 28,7 bar | 29,1 bar | 425 °C |

Operating pressure: 2 to 45 bar.

* According to EN1092-1:2018 ; ** According to EN1759-1:2004.

Body limiting conditions PN63 or below, depending on the type of connection adopted. Rating PN63 for thread, SW and BW.

| FLOW RATE CAPACITY (kg/h) | | | | | | | | | | | | | | |
|---------------------------|------------------|-----------------------------|------|------|------|------|------|------|------|------|------|------|------|------|
| MODEL | SIZE DN | DIFFERENTIAL PRESSURE (bar) | | | | | | | | | | | | |
| | | 2 | 4 | 6 | 8 | 10 | 12 | 16 | 18 | 20 | 24 | 26 | 32 | 35 |
| BM35 | 15 – 25 A | 550 | 780 | 880 | 900 | 920 | 935 | 950 | 980 | 1000 | 1030 | 1080 | 1130 | 1160 |
| BM35 | 15 – 25 B | 1500 | 1700 | 2000 | 2200 | 2500 | 2700 | 2990 | 3150 | 3400 | 3750 | 3880 | 4030 | 4200 |

A = Condensate discharge at 10 °C below saturation temperature. **B** = Cold water capacity at about 20 °C.

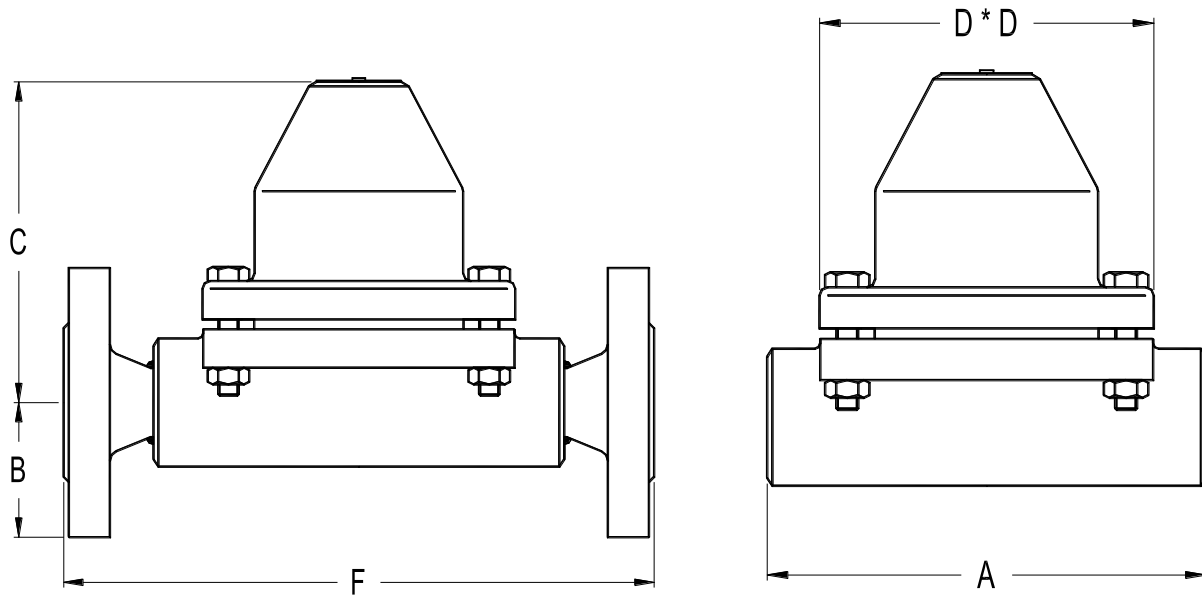

DIMENSIONS (mm)

| BSP – NPT – SW – BW | | EN 1092-1 PN40 | | | ANSI 300 lb | | | EN 1092-1 PN63 / PN100 | | | ANSI 600 lb | | | | | |
|---------------------|-----|----------------|-----|--------------|-------------|-----|--------------|---------------------------|-----|--------------|-------------|-----|--------------|------|-----|--------------|
| SIZE | A | C | D | WGT. (kg) | B | F * | WGT. (kg) | B | F * | WGT. (kg) | B | F * | WGT. (kg) | B | F * | WGT. (kg) |
| 1/2" – DN 15 | 160 | 120 | 115 | 6,3 | 47,5 | 230 | 7,9 | 47,5 | 230 | 8,2 | 52,5 | 230 | 8,8 | 47,5 | 230 | 8,2 |
| 3/4" – DN 20 | 160 | 120 | 115 | 6,3 | 52,5 | 230 | 8,5 | 59 | 230 | 9,4 | 65 | 230 | 11,1 | 59 | 230 | 9,4 |
| 1" – DN 25 | 160 | 120 | 115 | 6,3 | 57,5 | 230 | 9,1 | 62 | 230 | 10,2 | 70 | 230 | 11,8 | 62 | 230 | 10,2 |

*Note: Different face to face dimensions on request.

MATERIALS

| POS. N° | DESIGNATION | MATERIAL |
|---------|-------------------|---------------------------------------|
| 1 | Body | ASTM A105 / 1.0432 (Equiv. P250GH) |
| 2 | Cover | ASTM A105 / 1.0432 (Equiv. P250GH) |
| 3 | * Gasket | Stainless St. / Graphite |
| 4 | * Valve assembly | Hardened st. steel |
| 5 | * Strainer screen | AISI 304 / 1.4301 |
| 6 | * Seat gasket | AISI 304 / 1.4301 |
| 7 | Studs | ASTM A193 Gr. B7 |
| 7A | Nuts | ASTM A194 Gr. 2H |

* Available spare parts.

