



EPT-300 Series Pumping Trap

Carbon Steel, In-Line Connections

For capacities up to 9 040 kg/h (steam motive)... Discharge per cycle 45 liters

Condensate Recovery Equipment

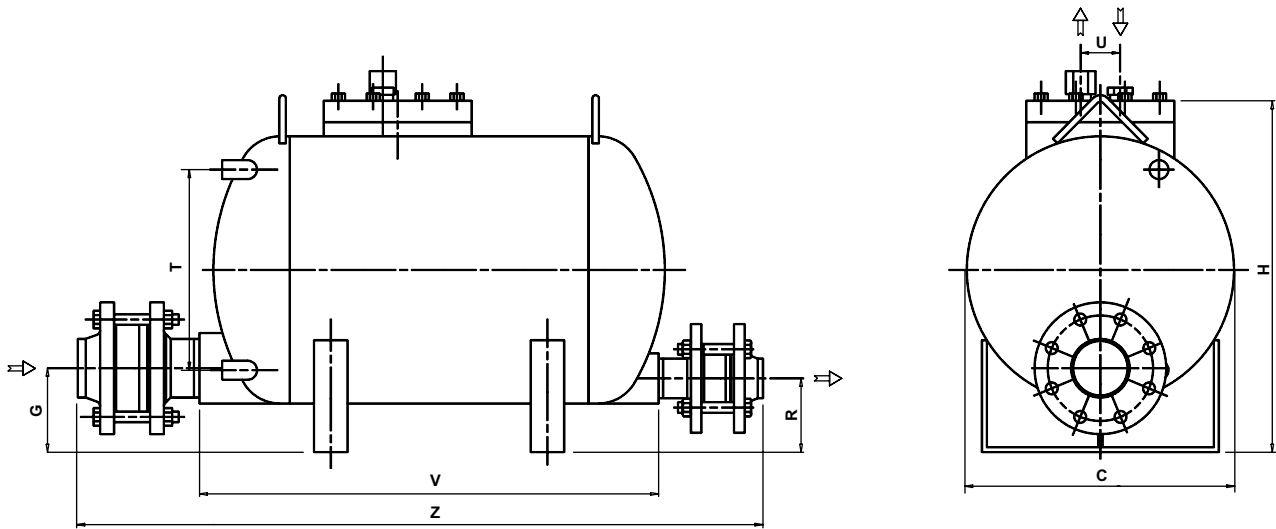

The Armstrong EPT-300 Series Horizontal, Low Profile Pump Trap is the low maintenance non-electric solution to move condensate or other liquids from low points, low pressures or vacuum spaces to an area of higher elevation or pressure. Condensate can be returned at temperatures well above the 99°C limit of conventional electric condensate pumps without the headaches of leaking seals or cavitation problems.

Features

- Non-electric – Uses inexpensive steam, air or gas to operate the pump trap
- Low profile – For tight space requirements
- High capacity – Provides highest capacity in the industry, moving 45 liters per pump cycle
- Explosion proof – Intrinsically safe
- ASME code stamped 150/300 carbon steel or stainless steel body vessel
- Low maintenance – No leaking seals, impeller or motor problems
- All stainless steel internals with durable Inconel X-750 springs
- Externally removable/replaceable seats – Valve and seats can be replaced or cleaned without removing pump cap from body



Table CRE-226-1. EPT-300 Pumping Trap Physical Data

Model Number	EPT-308	EPT-312
	mm	mm
«C» (diameter)	406	406
«G»	125	140
«H»	534	534
«R»	125	125
«T»	305	305
«U»	57	57
«V»	700	700
«Z»	1 017	1 045
Cap Removal	400	400
Weight (kg)	77	87
Number of Cap Bolts	8	8

Maximum Allowable Pressure (Vessel Design) 10 barg @ 250°C.
 Maximum Operating Pressure 9 barg.
 All models are CE Marked according to the PED (2014/68/UE).

All dimensions and weights are approximate. Use certified print for exact dimensions. Design and materials are subject to change without notice.

EPT-300 Series Pumping Trap

Carbon Steel, In-Line Connections

For capacities up to 9 040 kg/h (steam motive)... Discharge per cycle 45 liters



Component	Material
Body and Cap	Fabricated Carbon Steel ASME VIII division I - ASTM A106 GrB / ASTM A516 Gr60 / ASTM A105
Cap Gasket	Compressed Non-Asbestos
Bolts	SA - 193 gr B7
Inlet Valve Assembly	Stainless Steel
Vent Valve Assembly	Stainless Steel
Valve Assembly Washers	Zinc-Plated Steel
Mechanism Assembly	Cast Stainless Steel
Plug	Steel
Springs	Inconel X-750

Component	EPT-308	EPT-312
Inlet	DN 50	DN 80
Inlet Check Valve	DN 50	DN 80
Outlet	DN 50	DN 50
Outlet Check Valve	DN 50	DN 50
Motive Valve	1/2" BSPT	
Vent Valve	1" BSPT	
Gauge Glass	1/2" NPT	
Cycle Counter	1/2" NPT	

Motive Pressure	Total Lift or Back Pressure	EPT-308		EPT-312	
		DN 50 x DN 50		DN 80 x DN 50	
		Steam	Air	Steam	Air
bar	bar	kg/h	kg/h	kg/h	kg/h
1,0	0,35	3 130	4 175	4 080	5 580
1,7		4 620	4 945	5 990	6 440
3,5		4 810	5 035	6 850	7 170
5,0		4 900	5 125	6 940	7 305
7,0		5 080	On request	7 030	On request
8,5		5 260	On request	7 530	On request
1,7	1,0	3 175	4 580	4 080	5 080
3,5		4 355	4 945	5 805	6 260
5,0		4 875	5 035	6 440	6 805
7,0		4 945	On request	6 485	On request
8,5		5 130	On request	6 850	On request
2,5	1,5	3 220	4 175	3 675	5 215
3,5		3 765	4 630	4 630	5 785
5,0		4 580	4 990	5 670	6 125
7,0		4 630	On request	5 760	On request
8,5		4 670	On request	5 900	On request
3,5	3,0	2 585	3 450	2 995	4 445
4,0		2 995	3 990	3 810	4 760
5,0		3 450	4 580	4 445	5 760
7,0		3 810	On request	4 580	On request
8,5		4 265	On request	4 670	On request
4,5	4,0	2 040	3 175	2 720	4 630
5,0		2 130	3 220	2 905	4 720
7,0		2 905	On request	3 220	On request
8,5		2 995	On request	3 360	On request

Notes: Above capacities are the results of actual steam testing using a minimum 93°C condensate. Published capacities are based on the use of external check valves supplied by Armstrong. Fill head measured from drain point to top of pump cap. Discharge per cycle: 45 liters.

Model	Filling Head (mm)				
	0	150	300	600	900
EPT-308	0,70	0,90	1,00	1,20	1,30
EPT-312	0,70	0,85	1,00	1,08	1,20

Note: Filling head is measured from drain of receiver to top of pump's cap.

Options

- Gauge Glass Assembly with Guards (Brass or Cadmium Plated Carbon Steel)
- Digital Cycle Counter (Open or Closed Systems; with or without Auxiliary contacts)
- Insulation Jacket

This pump might be suitable for special applications. Please consult factory

All dimensions and weights are approximate. Use certified print for exact dimensions. Design and materials are subject to change without notice.

Condensate Recovery Equipment